

TAHITI | FRENCH POLYNESIA | FIJI | SOUTH PACIFIC

Charters, Meetings & Incentives

with

French Polynesia's
DESTINATION EXPERT

A wide-angle photograph of a tropical beach. In the foreground, a wide expanse of white sand is dotted with several people in swimwear, some standing and some lying on towels. To the left, a single palm tree stands near the water's edge. The water is a vibrant turquoise color, transitioning to a deeper blue further out. In the background, a large, rugged mountain with a flat top rises from the sea. The sky is a clear, bright blue with scattered white clouds.

Paul Gauguin
CRUISES

Welcome to Paul Gauguin Cruises

ARTFULLY AUTHENTIC DISCOVERY. ALL-INCLUSIVE LUXURY.

An **all-inclusive, luxury voyage** aboard the m/s *Paul Gauguin* is the **definitive choice** for discerning charter, meeting and incentive planners who seek a **truly authentic, small-ship experience** in the Islands of Tahiti and the South Pacific. Offering an immersive French Polynesian experience, *The Gauguin* is an extension of the islands themselves, **an overwater “bungalow” that sails** from one fabled destination to the next in seamless comfort.

With **more unique itineraries** than any other luxury cruise line—journeys of **7 to 20 nights** navigate the Society Islands, Tuamotus, Marquesas, Cook Islands, Fiji, Bali, and beyond—your clients will be spoiled for choice when choosing to explore with us. Our **award-winning** ship also offers more **private balconies** than any other vessel currently sailing in **French Polynesia year-round**, immersing your clients in the beauty of this cherished part of the world.

Our **experienced teams** ashore and aboard work in tandem to ensure every aspect of your **event is flawlessly executed**. Above all, with the genuine hospitality shared by **Les Gauguines**—our own troupe of local Tahitians who live aboard as hosts and entertainers—combined with **exacting service, French-inspired local cuisine**, and a **cheerful *joie de vivre***, your event is sure to exceed the expectations of your clients.

We are honored to be **French Polynesia’s destination expert**, and we will be thrilled to host your client’s next corporate meeting, charter, incentive program or special event.

Closer Than You Think

The ultimate escape to paradise, Tahiti and French Polynesia are actually in the same time zone as Hawaii and only two hours away. Once there, your clients will enjoy unmatched, up-close views of one of the world’s most beautiful destinations from a sleek and nimble ship designed specifically to sail these seas.

*Only 8.5 hours (nonstop) from
Los Angeles to Papeete, Tahiti*



[The Gauguin Experience ▶](#)



The Gauguin Experience

WHY PAUL GAUGUIN CRUISES

- Intimate, small-ship ambiance with **no more than 330 guests**
- **Impeccable service** with an industry-leading 1:1.5 crew-to-guest ratio
- **Private balconies** in nearly 70% of our suites and staterooms
- **Nightly entertainment**, special guests, and Les Gauguines—*The Gauguin's* own troupe of up to eight Polynesian entertainers who live aboard ship to share their culture
- Presentations by **local naturalists** and a variety of special guests on select sailings
- Optional onboard **PADI dive program** with Zodiacs® launched from ship's marina for diving excursions; also offering novice certification, refresher courses, nitrox dives, and more

ALL-INCLUSIVE FARES

- **Gourmet dining** in three unique venues, plus **24-hour room service**
- Welcome **Champagne** and selection of **fine wines, spirits, and beers**
- **In-suite bar** setup and **butler service** in categories B and above
- **Stateroom minibar** replenished daily
- All onboard **gratuities**
- **Watersports** from the retractable marina platform
- Exclusive **private island** and beaches
- **Unlimited Wi-Fi** throughout the ship

SHIP STATISTICS

Capacity.....	330 Guests	Length.....	504'
Crew	217 / International	Width	72'
Crew-to-Guest Ratio	1:1.5, one of the highest of any cruise ship	Draft	17.1'
Officers	European & International	Tonnage.....	19,200 Tons
Registry.....	Wallis and Futuna (Mata Utu)	Maximum Speed	18 Knots
Shipyard	Chantiers de l'Atlantique (Saint Nazaire, France)	Passenger Decks	7
		Call Letters	C6TH9
		Propulsion System	Diesel Electric

Value Comparison ►

Life Aboard

This part of the world is a dream destination, and we offer many ways for our guests to enjoy an enhanced experience of the welcoming, hospitable spirit of Polynesia.

LES GAUGUINES & LES GAUGUINS | As soon as your clients step aboard, they'll be greeted by our beloved troupe of local Tahitians who serve as cruise hosts and entertainers; from sharing tales of island legends and offering Tahitian language and dance lessons to making traditional shell jewelry or showing the various ways to tie a *pareo*, they add a uniquely enriching dimension to every voyage.

ENTERTAINMENT & ENRICHMENT | On select voyages, special guests are invited on board to host lectures, performances, workshops, wine tastings, cooking demonstrations, and more. These itineraries offer your clients insight on a wide range of topics from art, wine, and cuisine to South Pacific history, culture, and science.

ALGOTHERM DERMO OCEAN SPA | Our award-winning spa invites your clients to indulge in the serenity of days at sea. With treatments inspired by the ocean, the spa's approach to holistic beauty and rejuvenation combines the qualities of expert marine biotechnologies with the art of skilled touch. Sessions are tailored to individual needs with an extensive array of services from massage therapies and reflexology to facials, exfoliation, beauty treatments, hair styling, and nail care.

SPECIAL EVENTS & CELEBRATIONS | Paul Gauguin Cruises is also experienced in creating unforgettable celebrations. We are renowned for the extra touches and attention to detail that make every occasion memorable. Optional packages curated for milestone celebrations and Gift Registries are also available.



7
NIGHTS

OUR SIGNATURE CRUISE ITINERARY

Tahiti & the Society Islands

The 118 islands and atolls (ring-shaped coral reefs) of French Polynesia shimmer like a string of prized Tahitian pearls scattered across a cerulean sea. At the heart of every itinerary lay Tahiti and the Society Islands, the fabled archipelago that has inspired generations of artists and writers seeking to capture their magical allure. Among countless others, Herman Melville, James A. Michener, Henri Matisse—and, of course, Paul Gauguin himself—were transfixed by these islands, and your clients will be too. Our signature 7-night itineraries visit Tahiti, Huahine, Motu Mahana (our private islet in the Taha'a lagoon), Bora Bora, and Moorea.

ITINERARY HIGHLIGHTS

- Overnights in Bora Bora, Moorea, and Papeete, renowned for their lagoons and iconic mountain peaks
- The lush rainforest and archaeological treasures of Huahine, known as "The Garden Island"
- An exclusive day at Motu Mahana, featuring an authentic Polynesian barbecue, entertainment, and a floating bar

Building on our core destinations in the Society Islands are our longer voyages of 10, 11, and 14 nights that incorporate discovery of the Tuamotus, Cook Islands, Marquesas, and beyond. To explore the South Pacific is to be forever changed by her beauty, and our rich collection of itineraries reveals the treasures found here with artful authenticity. To view the full selection of itineraries available, visit: pgcruises.com/cruises.



Map not drawn to scale

Sailing Schedule ►



Enhance the Journey

Pre- and Post-Cruise

A trip to French Polynesia is a once-in-a-lifetime experience, and to elevate your clients' travels before and after their voyage we offer a collection of **pre- and post-cruise programs**. These include air travel, tour, and transfer arrangements; pre- and post-cruise dayroom(s); and extended stays at premier resorts.

**Pre- and Post-cruise
Resort Programs ▶**

Shore Excursions

Aboard *The Gauguin*, your clients will enjoy a wide array of optional shore excursions by land and sea that let one discover the vivid beauty, vibrant history, and rich culture of this destination up close, in a small group.

pgcruises.com/shore-excursions

Shore excursions can be booked within 60 days of sailing date.



Exceptional Dining

With three unique restaurants, your clients will savor a variety of delectable culinary options as each venue features its own menu and team of talented chefs. Plus, with no scheduled mealtimes or seating plans, they'll dine when and where they wish. Attire is resort casual—no formal nights, ever—so it's okay to leave the ties at home.



» **L'Etoile** Exquisite main dining room offering tantalizing menus of global fare and the bounty of the sea paired with complimentary wines.

HIGHLIGHTS: Local yellowfin tuna and chilled local papaya and ginger soup.

Deck 5 (Capacity: 208 seats) Dinner only; no reservations required; open seating; space can be used during the day for meetings (classroom style, up to 30 seats)



» **La Veranda** Upscale French restaurant featuring authentic French cuisine.

HIGHLIGHTS: A degustation dinner menu with escargot, *foie gras*, and other French delicacies.

Deck 6 (Capacity: 160 total; 108 seats indoor + 52 seats outdoor) Open for breakfast, lunch and dinner (reservations required for dinner only)



» **Le Grill** Pool-adjacent *al fresco* venue is the go-to spot for a fresh breakfast, salads and grilled options for lunch, and Polynesian specialties for dinner.

HIGHLIGHTS: Ahi poke and coconut shrimp.

Deck 8 (Capacity: 92 seats) No reservations required; breakfast and lunch; *al fresco* seating



» **La Palette** Indoor/outdoor aft location; casual lounge serves a late riser's breakfast and afternoon tea.

HIGHLIGHTS: Evening cocktails with extraordinary views of French Polynesia.

Deck 8 (Capacity: 105 total; 39 seats indoor + 46 seats outdoor + 20 standing) Versatile lounge for lectures, activities, and evening music; late-risers breakfast

Room Amenities

AVAILABLE IN ALL CATEGORIES

Flat-screen TV, international channels, videos on demand | Stocked minibar | Individually-controlled air conditioning
Dressing table, hairdryer | Algoterm Spa bath amenities | Electronic safe | 24-hour room service | Wi-Fi

Category OS Owner's Suite | Deck 7 (2) | Butler service* | Private veranda

OWNER'S SUITE OS 701



457 sq. ft. + 77 sq. ft. veranda

OWNER'S SUITE 701

Bathroom with a bathtub and a separate shower, plus a dressing area

OWNER'S SUITE 7002

Bathroom with a bathtub and dressing area

- Separate bedroom with one queen-size bed or two single beds
- Lounge with sofa bed, two armchairs and dining table for four
- Private transfers to and from the ship
- Priority embarkation
- Premium Champagne upon arrival
- Fruit basket upon arrival, replenished during cruise
- Fresh flowers upon arrival
- Two complimentary 50-minute spa treatments
- Invitation to a dinner with Captain or Hotel Director
- Daily canapés according to guest preferences

OWNER'S SUITE OS 7002

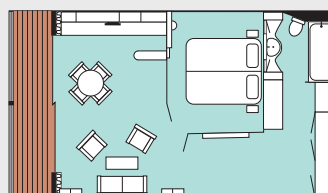

531 sq. ft. + 57 sq. ft. veranda

Category GS Grand Suite | Deck 8 (2) | Butler service* | Private Veranda

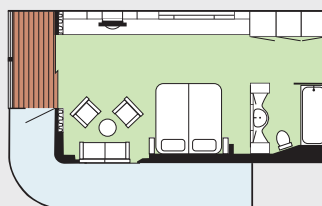

332 sq. ft. + 179 sq. ft. veranda

- One king-size bed, or two single beds
- Sitting area with two armchairs and loveseat sofa bed
- Bathroom with a bathtub and shower
- Private transfers from the ship to the airport
- Priority embarkation
- Premium Champagne upon arrival
- Fruit basket upon arrival, replenished during cruise
- Fresh flowers upon arrival
- Two complimentary 50-minute spa treatments
- Invitation to a dinner with Captain or Hotel Director
- Daily canapés according to guest preferences

**Butler service includes, but not limited to: Personalized assistance for luggage (during embarkation and disembarkation). Arrangement of clothes for ironing or laundry. In-suite cocktail party arrangements. Restaurant reservations. For more information visit: pgcruises.com/butler-service*

Category A Veranda Suite | Deck 7 (5) | Butler service* | Private veranda

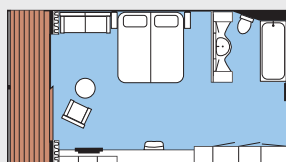

300 sq. ft.
+ 58 sq. ft. veranda

- One king- or queen-size bed, or two single beds
- Sitting area with armchair and loveseat sofa
- Floor-to-ceiling glass doors
- Bathroom with full-size tub and shower
- Priority embarkation
- Fruit basket upon arrival, replenished during cruise
- Fresh flowers upon arrival
- Daily canapés according to guest preferences

Category B Veranda Stateroom | Deck 8 (17) | Butler service* | Private veranda

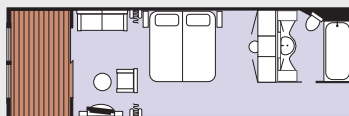

249 sq. ft. + 56 sq. ft. veranda

- One king- or queen-size bed, or two single beds
- Sitting area with armchair and loveseat sofa
- Panoramic sliding bay window
- Bathroom with bathtub or shower
- Priority embarkation
- Fruit basket upon arrival
- Daily canapés according to guest preferences

Category C & D Balcony Stateroom | Deck 7 (63) | Deck 6 (26) | Private veranda



202 sq. ft.
+ 37 sq. ft. veranda

- One queen-size bed or two single beds
- Bathroom with full-size tub and shower

Category E Window Stateroom | Deck 4 (37)

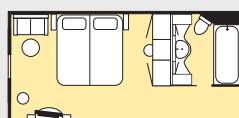

200 sq. ft.

- One queen-size bed or two single beds
- Panoramic window
- Bathroom with a full-size tub and shower

Category F Porthole Stateroom | Deck 7 (13)

200 sq. ft.

- One queen-size bed or two single beds
- Two portholes
- Bathroom with full-size tub and shower

Category F Porthole Staterooms floorplan are exactly the same as Category E except that they feature two portholes instead of a window.

[Videos & Additional Details ▶](#)

Deck Plan

- OS Owner's Suite
- GS Grand Suite
- A Veranda Suite
- B Veranda Stateroom
- C Balcony Stateroom
- D Balcony Stateroom
- E Window Stateroom
- F Porthole Stateroom

- Denotes stateroom with two twin beds that convert to a queen. Stateroom 801 offers a king-size bed.
- + Denotes stateroom with triple occupancy.

Note: Loveseat beds are slightly smaller than a standard twin bed.

Staterooms 415 and 416 are wheelchair accessible.

Suites and staterooms range from 200 to 588 square feet. This measurement includes balconies and verandas in categories D and above.

DECK NINE

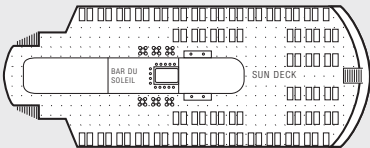

DECK EIGHT

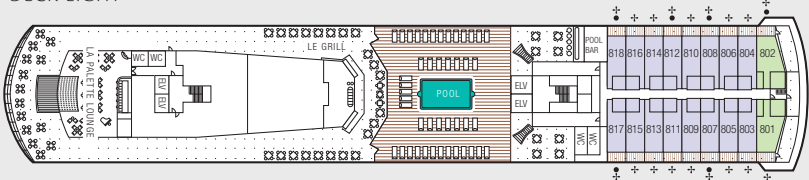

DECK SEVEN

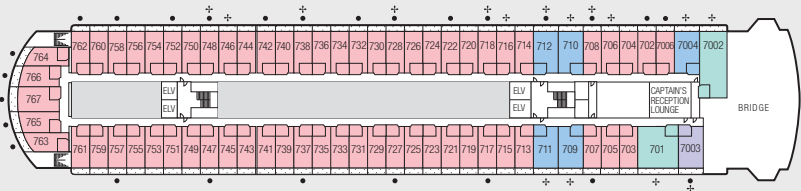

DECK SIX

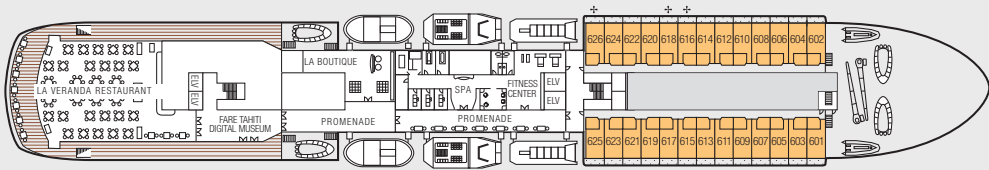

DECK FIVE

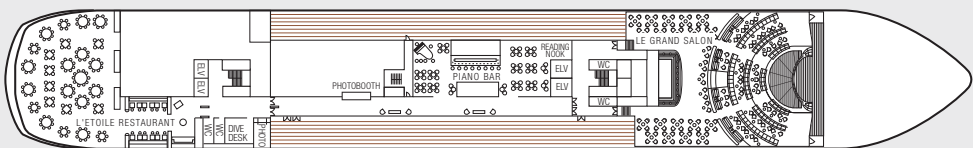

DECK FOUR

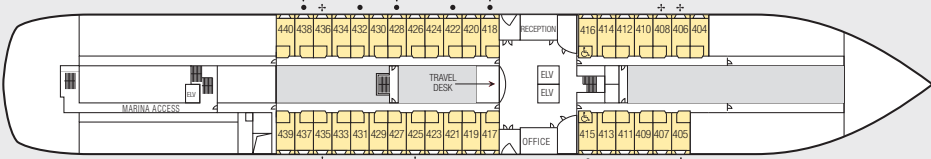

DECK THREE

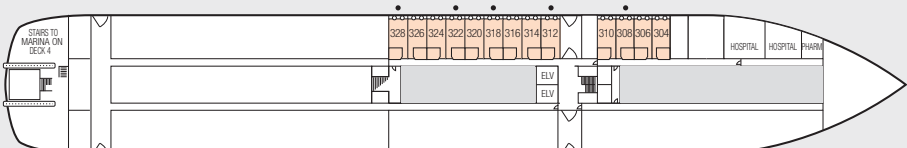

» LOBBY & RECEPTION

Concierge and Excursion Desks

Deck 4 Can accommodate a Hospitality Desk

» DINING OPTIONS

Please see page 7

» ENTERTAINMENT & NIGHTLIFE

Le Grand Salon

Deck 5 (Capacity: 280 total; 231 seats + 50 standing) Spectacular performances featuring the culture of the islands and more; space can be used during the day for meetings and cocktail parties in the evening

La Palette

Deck 8 (Capacity: 105 total; 39 seats indoor + 46 seats outdoor + 20 standing) Versatile lounge for enrichment lectures, special activities, and live evening music; space can be used during the day for meetings

Piano Bar

Deck 5 (Capacity: 104 total; 84 seats + 20 standing) Relaxed ambiance and live entertainment; space can be used during the day for small group meetings and larger cocktail parties in the evening

Bar du Soleil

Sun Deck (Capacity: 136 total; 36 seats + 100 standing) Space can be used for cocktail parties

Pool & Pool Bar

Deck 8 (Capacity: 102 total; 52 seats + 50 sun chairs) Space can be used for cocktail parties only for charters

Captain's Reception Lounge

Deck 7 (Capacity: 36 total; 16 seats + 20 standing) Used for private cocktail parties and lectures for small groups; Moana Explorer Program for kids on select sailings

» SPA & FITNESS

Algotharm Dermo Ocean Spa

Deck 6 (1,767 sq ft) Shipboard treatments include skin care therapies, skin exfoliation, massage, reflexology, body wraps, facials, beauty treatments, nail services, and hair styling.

Fitness Center

Deck 6 (381.4 sq ft) Fully equipped with a wide range of Technogym equipment

Spa Menu ►



La Palette

» OTHER ONBOARD SERVICES

La Boutique

Deck 6 Featuring authentic Tahitian pearls, resort wear and logo apparel, specialty gifts, and selection of sundries

Fare Tahiti Museum

Deck 6 Reading Gallery featuring historical Tahitian artifacts and artwork from local artists

Reading Nook – Deck 5

Photo Studio – Deck 5

Table Tennis – Deck 5

Inside Le Grand Salon

Walking Track – Deck 9

Afternoon Tea

Le Grill or La Veranda

» WATERSPORTS & SWIMMING

Watersports Marina

Deck 3 Complimentary use of snorkel gear throughout the voyage, plus kayaking and paddleboarding available from the retractable marina platform and/or our private white-sand beach on a motu off the coast of Bora Bora* and from the beach of our own private motu off the coast of Taha'a.

Dive Desk

Deck 5 Arrange SCUBA tours at the dive desk. *The Gauguin* offers SCUBA diving for all levels of experience and is the only luxury ship in the French Polynesian islands with its own diving team, offering PADI certification on board for novice divers, as well as refresher courses. For more information visit: pgcruises.com/scuba



Le Grand Salon



Piano Bar



Algotharm Dermo Ocean Spa



Watersports Marina

*Subject to availability as conditions allow. When unable to call there, we will be offering a tender to the pier and a free shuttle to Matira Beach, the island's award-winning public beach.



We are eager to host your next charter, meeting, or incentive program in French Polynesia aboard the m/s *Paul Gauguin*. Our experienced teams have all the tools you need to organize and promote your event—from brainstorming creative themes and arranging flights, transfers, and tours to providing destination and ship photography, deck plans, suite/stateroom floorplans, public/meeting space details, and more.

The Gauguin features a variety of meeting spaces easily arranged to accommodate your event needs, and a range of A/V equipment is also available.

Let us help you create an effective—and unforgettable—event for your charter, meeting, or incentive program clients. Contact us today!



Rita Chenique

Director,
Business Development –
Group, Charter and Latin
America Sales
rchenique@ponant.com
(646) 517-0336



Damaris Mesa

Account Manager, Business
Development – Group, Charter
and Latin America Sales
dmesa@ponant.com
(646) 517-0350

Frequently Asked Questions ►

Paul Gauguin
CRUISES

1767248R

We Care

Paul Gauguin Cruises was created with the intent to provide enjoyable and meaningful travel experiences to this unique part of the planet. We care deeply, not only for our guests, but for the communities, cultures and natural wonders that make Tahiti, French Polynesia, and the South Pacific so alluring. We are dedicated to minimizing our environmental footprint and supporting local communities, while maximizing your experience of Polynesia's vivid, vibrant cultures, and stunning natural beauty. For more information visit: pgcruises.com/we-care